

## Handling System for Hood type Sorting Table Right to Left, 1700x1100mm

ITEM # \_\_\_\_\_

MODEL # \_\_\_\_\_

NAME # \_\_\_\_\_

SIS # \_\_\_\_\_

AIA # \_\_\_\_\_



865342 (BHST1711R)

Sorting table, Right>Left,  
1700x1100 mm

### Short Form Specification

**Item No.** \_\_\_\_\_

Constructed in 304 AISI stainless steel. N. 4 square 40x40mm tubular legs on height-adjustable feet. Underframe on three sides.

1-tier overshelf for baskets. N. 1 waste scraping hole with rubber ring. Attachment to infill tops or slide conveyors on the left side. Basket direction: from right to left.

### Construction

- All surfaces smooth with polished finish.
- Receiving tabletop with raised side edges all-round, reduces the possibility of crockery being pushed off the table.
- Constructed in AISI 304 stainless steel with square 40x40mm legs.
- One or two waste holes with a rubber scraping ring tabletop.
- Sorting table provided with an over-shelf for dishwashing racks which can be inclined at either the dishwashing or receiving side.

### Sustainability

- Optional extras: plain tray slider, cutlery chute or additional scraping hole.

### Optional Accessories

- |  |            |                          |
|--|------------|--------------------------|
| • Dish scraper                             | PNC 855297 | <input type="checkbox"/> |
| • Shelf for plates and baskets, 1700 mm    | PNC 865376 | <input type="checkbox"/> |
| • Tray slide for sorting table, 1700 mm    | PNC 865380 | <input type="checkbox"/> |
| • Cutlery chute to install on tray slide   | PNC 865383 | <input type="checkbox"/> |
| • Floor fastening kit for 2 square legs    | PNC 865386 | <input type="checkbox"/> |
| • Removable bridge table, 800 mm           | PNC 865418 | <input type="checkbox"/> |
| • Removable bridge table with hole, 800 mm | PNC 865419 | <input type="checkbox"/> |

APPROVAL: \_\_\_\_\_

# Handling System for Hood type Sorting Table Right to Left, 1700x1100mm

## Key Information:

External dimensions, Width:	
865342 (BHST1711R)	1700 mm
External dimensions, Depth:	1100 mm
External dimensions, Height:	1551 mm
Net weight:	15 kg

**Front**

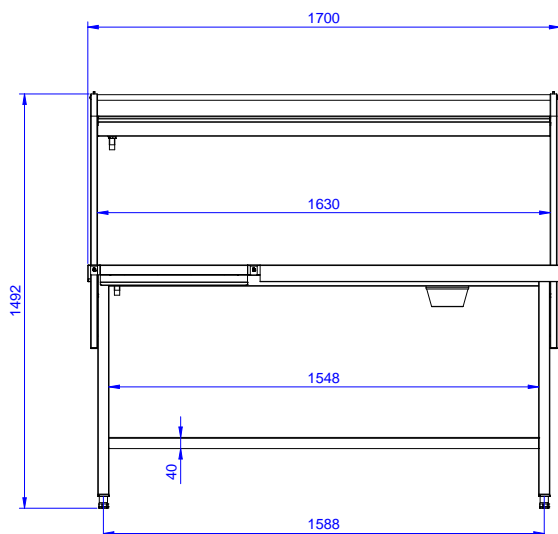

**Side**

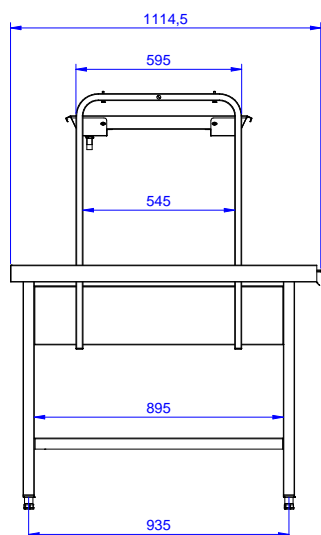

**Top**

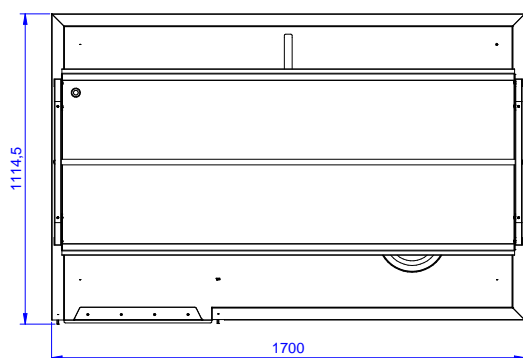

Handling System for Hood type  
 Sorting Table Right to Left, 1700x1100mm

The company reserves the right to make modifications to the products without prior notice. All information correct at time of printing.